

MADJAX

Part # 01-042/48 Genesis 250/300 Rear Seat

(will fit Club Car® DS®)



ITEMS INCLUDED

- Hardware Packs 1-8
- Grab Bar
- Lean Back Brackets
- Back Bracket
- Armrest
- Footrest
- Main Frame

TOOLS NEEDED

- Drill
- 17mm Socket
- 17mm Wrench
- 14mm Socket
- 10mm Socket
- #3 Phillips Bit
- 13mm wrench

Only needed
for premium seats



Lean Back
Brackets
(Sold with 250/300
Cushions)



Bagwell Bracket



Grab Bar



Armrests



Main Bracket



Footrest



Main Frame



Struts

WARNING:

Madjax recommends professional installation. If you choose to not have this product installed by a professional, we highly recommend that you exercise caution, care, and patience when installing this product as it involves drilling holes into your cart's body.

STEP 1

Remove all rear accessories (if any), struts, bumper, motor cover, front seat and bracket. Retain canopy hardware and all front seat mounting hardware. Use brace to support canopy.



STEP 2

- Attach main brackets to cart, above battery compartment with retained hardware.
- Using 8mm hardware from Pack 1 mount middle to cart as shown.
- Strut should be aligned to the inside of main bracket as shown.

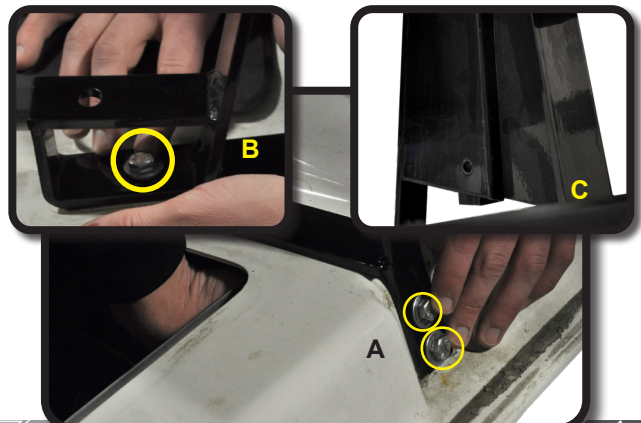

STEP 3

Attach bagwell bracket to frame as shown using hardware from pack 2 and tighten.



STEP 4

Attach main frame to main seat bracket using hardware from pack 2 and tighten.

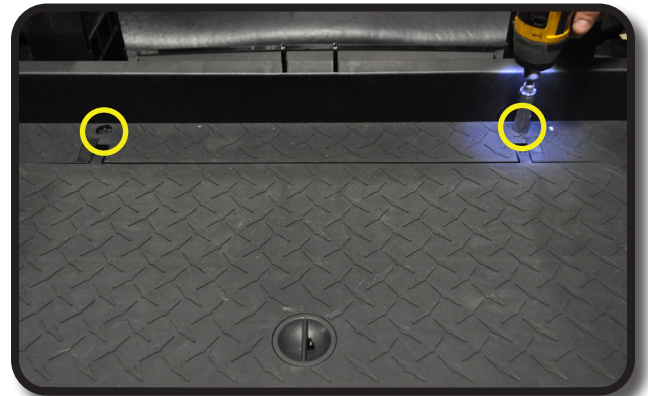

STEP 5

Attach bagwell bracket to polyboard seat frame as shown using hardware from pack 2. Repeat process on other side.



STEP 6

Attach arm rest to polyboard seat frame as shown using hardware from pack 3.



STEP 7

If using 250/300 seat cushion, attach lean back bracket that was packaged with the cushions. Using appropriate hole for your cart attach lean back brackets to main seat bracket using hardware from Pack 4.

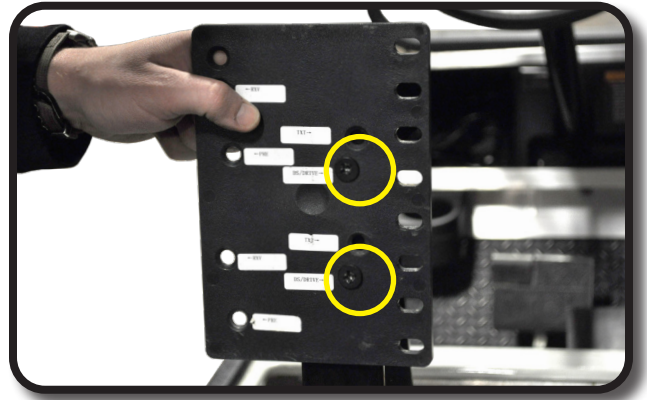

STEP 8

Choose desired height, and attach lean back cushion to bracket as shown using hardware from Pack 5.

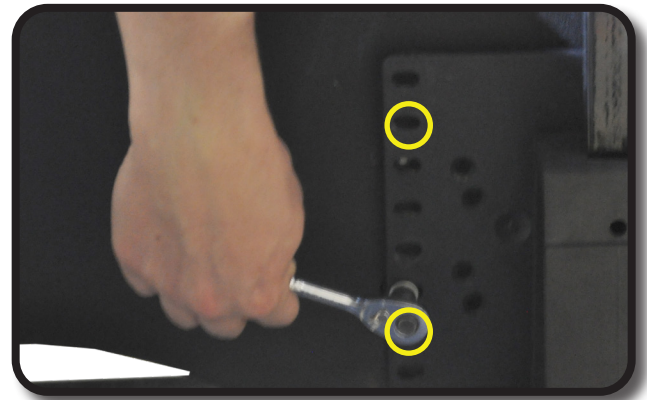

STEP 9

Attach footrest to bagwell bracket as shown using 10mm hardware from Pack 6. Repeat process on the other side.



STEP 10

Attach grab bar to footrest as shown using 10mm hardware from Pack 6.

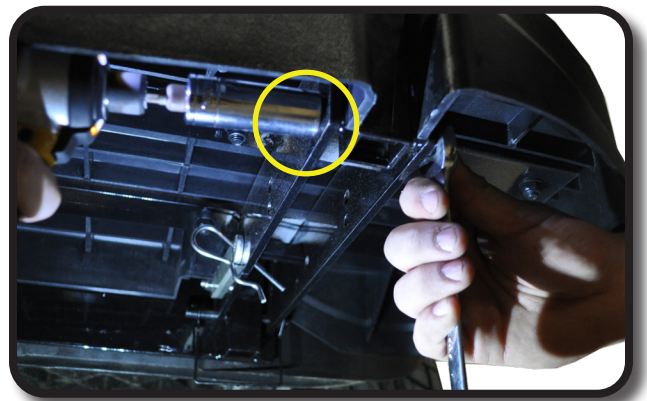

STEP 11

Using quick release clips from hardware Pack 6 Secure footplate to bagwell bracket and grab bar as shown.

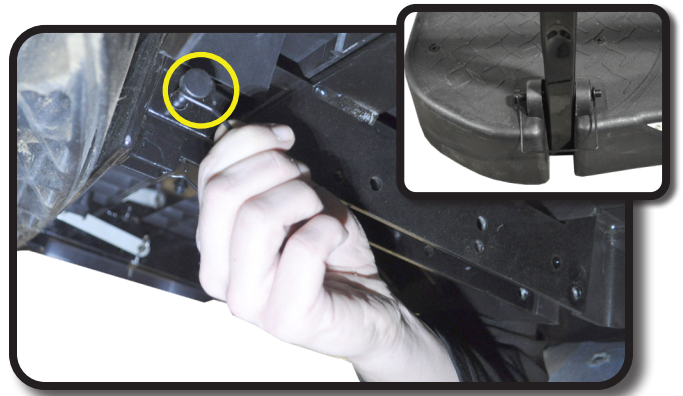

STEP 12

Attach seat bottom cushion as shown using hardware from Pack 7.



STEP 13

Re-attach roof using hardware retained from Step 1 as shown. Attach struts to main bracket using hardware from Pack 8.



STEP 14

Footplate can be folded up by removing the four quick release clips and folding forward. To lock footplate in up right position use brackets as shown.

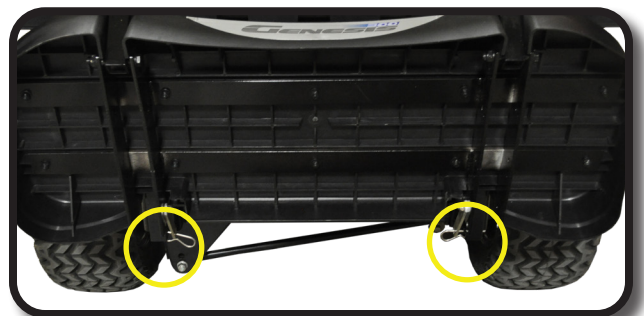

INSTALLATION COMPLETE

HARDWARE PACK

WARRANTY PARTS EXPLODED VIEW DIAGRAM

Pack 1

- 2 – 8x30mm hex bolt
- 4 – 8x17mm flat washer
- 2 – 8mm lock nut

Pack 2

- 2 – 8x60mm hex bolt
- 4 – 8x15mm flat washer
- 2 – 8mm lock nut
- 2 – 10x30mm hex bolt
- 8 – 10x20mm flat washer
- 4 – 10mm lock nut
- 2 – 10x50mm hex bolts
- 12 – Rubber washers

Pack 3

- 4 – 8x30mm hex bolt
- 4 – 8x15mm flat washer

Pack 4

- 4 – 8x30mm countersunk #3 Phillips
- 4 – 8x15mm flat washer
- 4 – 8mm locknut

Pack 5

- 4 – 6x25mm hex bolt
- 4 – 6x15mm flat washer
- 4 – 6mm lock washer

Pack 6

- 4 – 10x75mm hex bolt
- 8 – 10x20mm flat washer
- 4 – 10mm Locknut
- 4 – Quick release pins (easy remove hardware for folding in the foot plate)
- 8 – Rubber washers

Pack 7

- 8 – 8x40mm countersunk

Pack 8

- 4 – 8x45mm Hex bolt
- 8 – 8x17mm flat washer
- 4 – 8mm locknut

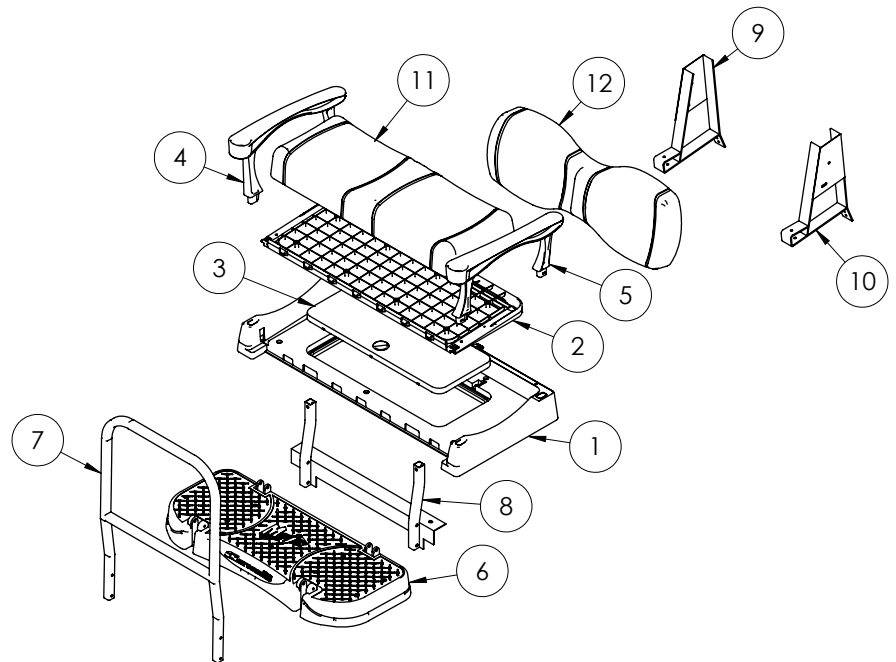

14 Rear Struts-Driver Side (Not Shown in Diagram)

15 Rear Struts-Pass Side (Not Shown in Diagram)