

Installation & Operations Manual for Rear View Mirror

Halo Rear View Mirror
 18053 – Defender Clamp
 18055 – 1.625" Clamp
 18056 – 1.75" Clamp
 18057 – 2" Clamp
Round Tube Clamp Mounting:
 18058 – Pro-Fit Clamp
 18059 – X3 Clamp

Contents:



Mirror

Round Tube Roll cage clamp



Mirror Arm

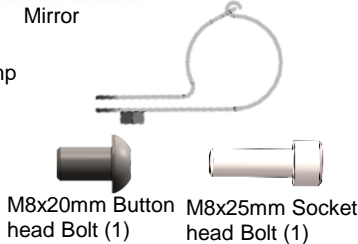

M8x20mm Button head Bolt (1)

M8x25mm Socket head Bolt (1)

Installation & Operations Manual for Rear View Mirror

X3 Clamp Mounting:

Contents:



Mirror

M6 nylok nuts (2)

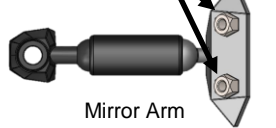

Mirror Arm



X3 Badge Plate

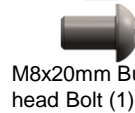

M8x20mm Button head Bolt (1)



M6x20mm Button head Bolt (2)

Installation: For vehicles with round front cross tubes.

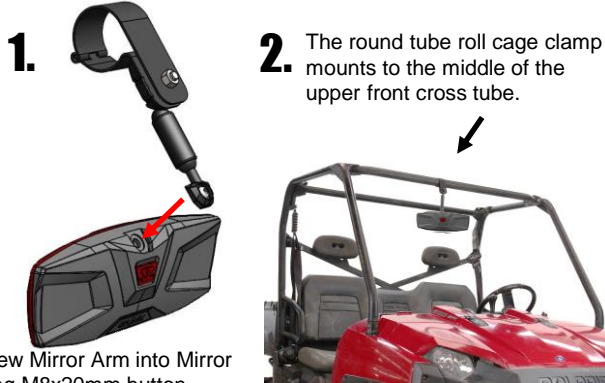

1. Screw Mirror Arm into Mirror using M8x20mm button head bolt.

2. The round tube roll cage clamp mounts to the middle of the upper front cross tube.

Installation: Cam Am X3 with rear view mounting plate.

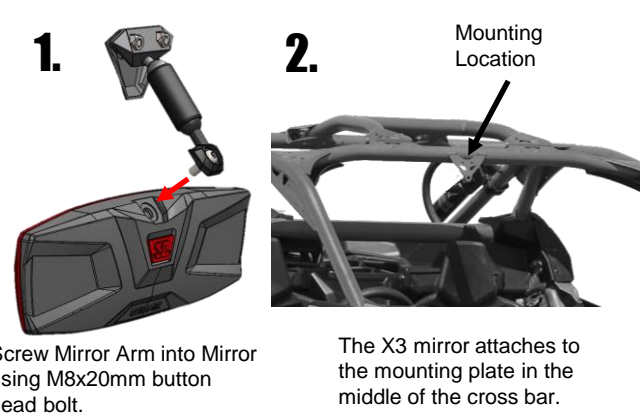

1. Screw Mirror Arm into Mirror using M8x20mm button head bolt.

2. The X3 mirror attaches to the mounting plate in the middle of the cross bar.

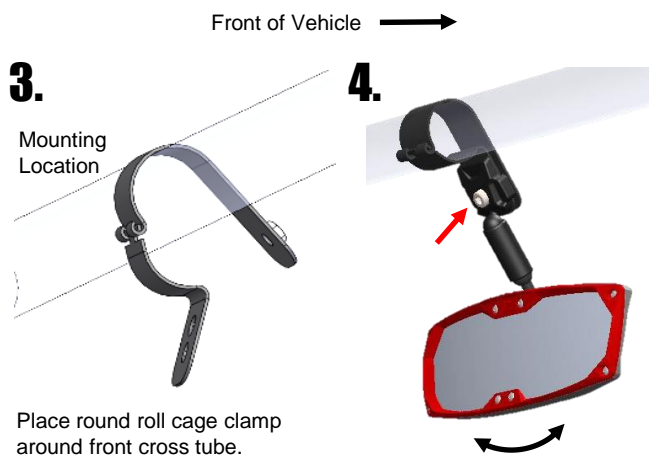

3. Place round roll cage clamp around front cross tube.

4. Line up the mirror with arm attached and install using M8 x 25mm socket head bolt. Adjust mirror as necessary.

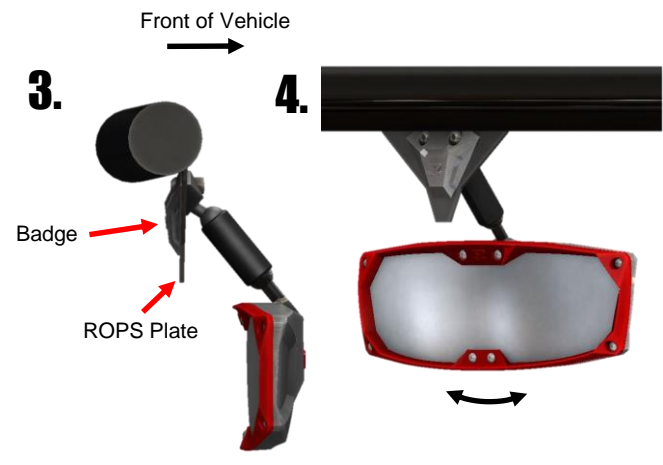

3. Place brackets and badges as shown. Use M6x20mm button head bolts to secure mirror to ROPS plate.

4. With the mirror secured to the ROPS plate using the 2 M6x20mm button head bolts, adjust mirror for best visibility.